



SPONSOR:

BILL: _____

Paradise Hills Community Center Phase II and III Redevelopment

\$1.2 million is requested to purchase plan, design and construct improvements and additions to the Paradise Hills Community Center and adjacent parks and recreation facilities, including renovations of Paradise Hills Park, new parking for Center use, a new additions to the Community Center and Annex, and ancillary site engineering and landscaping.

The initial building of the Paradise Hills Community Center was constructed in 1986 adjacent to Paradise Hills Park. The aquatic facility and other site amenities were added in the 1990's and building and land that became the Annex was secured in the early 2000's. Recently the Annex was renovated to accommodate a Senior Meal site and other Adult and Senior oriented activities, and the Center main building was renovated for the Parky's Pals programs. Currently, the center is the most heavily used Center in the County's portfolio, with more than half the applicants for after school and summer programs being turned away. The gym is the only County controlled facility in an area that has over a hundred basketball teams vying for limited Gym space. The Center is only one of two community centers on the West Side north of I-40 and west of the River, and the only Senior facility in that same area.

This request would enable the County to (1) undertake key traffic safety measures for child pedestrians, including a stop light at the La Paz intersection, a raised crossing between the Center and the Park, better parking along the Park and Center site, and other crossing measures for Paradise Hills Boulevard (2) to plan, design and construct renovations to Paradise Hills Park, including a band shell landscape viewing area for the main field and upgrades to the existing skate park, (3) design and construct additional parking for the Center and Annex, and (4) plan and design additions to the Annex and the main Center building.

Fifty First Legislature, Second Session, 2014

AR 2014-2, #13.A4.CS. Paradise Hills CC
House #
Senate #
Commission 4

Paradise Hills Community Center Cluster Master Plan

Bernallille County
Parks & Recreation
December 2013

Contact: John Barney, BCRP Planning Manager
[cbarney@bermo.gov / 505.314.0404]



Phasing / Cost

Phase	Description	Cost
Phase 1 ANNEX TRAIL / PARKING	1A Prescription for trail around Annex	\$80,000
	1B New 24 spaces parking north of Paradise Blvd	\$125,000
	1C Additional parking on adjacent street (pending)	\$ N/A
Phase 2 SITE / PARKING IMPROVEMENTS	2A Traffic warrant study & traffic light at La Paz & Paradise	\$270,000
	2B Pedestrian crosswalk across Paradise at Annex	\$6,000
	2C Parking around Paradise Park, pedestrian crossing plaza from Center to Park, Park	\$275,000
	2D New basketball structure in Park	\$350,000
	2E New advanced level skate park in Park	\$300,000
	2F Connect PHCC trails to Bernos & offsite trails	\$150,000
Phase 3 BASALT HILL PARKING / SITE IMPROVEMENTS	3A Central parking area through site from Paradise to Chiquanal	\$175,000
	3B New landscaping through central area incl: drainage improvements A,B & C	\$125,000
	3C Landscaping around existing building	\$60,000
	3E Outdoor basketball courts & landscaping	\$75,000
Phase 4 PHCC MAIN ADDITION	4A PHCC main, admin, classrooms, fitness, locker, racquetball (24,000 sf)	\$5,500,000
	4B Courtyard	\$275,000
Phase 5 GYM	5A New gymnasium & support spaces	\$2,800,000
	5B Landscaping at entry & gym (12,000 sf)	\$80,000
Phase 6 PHCC ANNEX ADDITION	6A Annex building additions	\$1,800,000
	7A Original building upgrade (8,000 sf)	\$3,000,000
Phase 7 PHCC RENOVATION	7A Original building upgrade (8,000 sf)	\$3,000,000
	EXISTING exterior pool improvements	\$2,500,000
Phase 8 EXISTING OUTDOOR POOL UPGRADES	EXISTING exterior pool improvements	\$2,500,000
	Phase 2 SITE / PARKING IMPROVEMENTS	

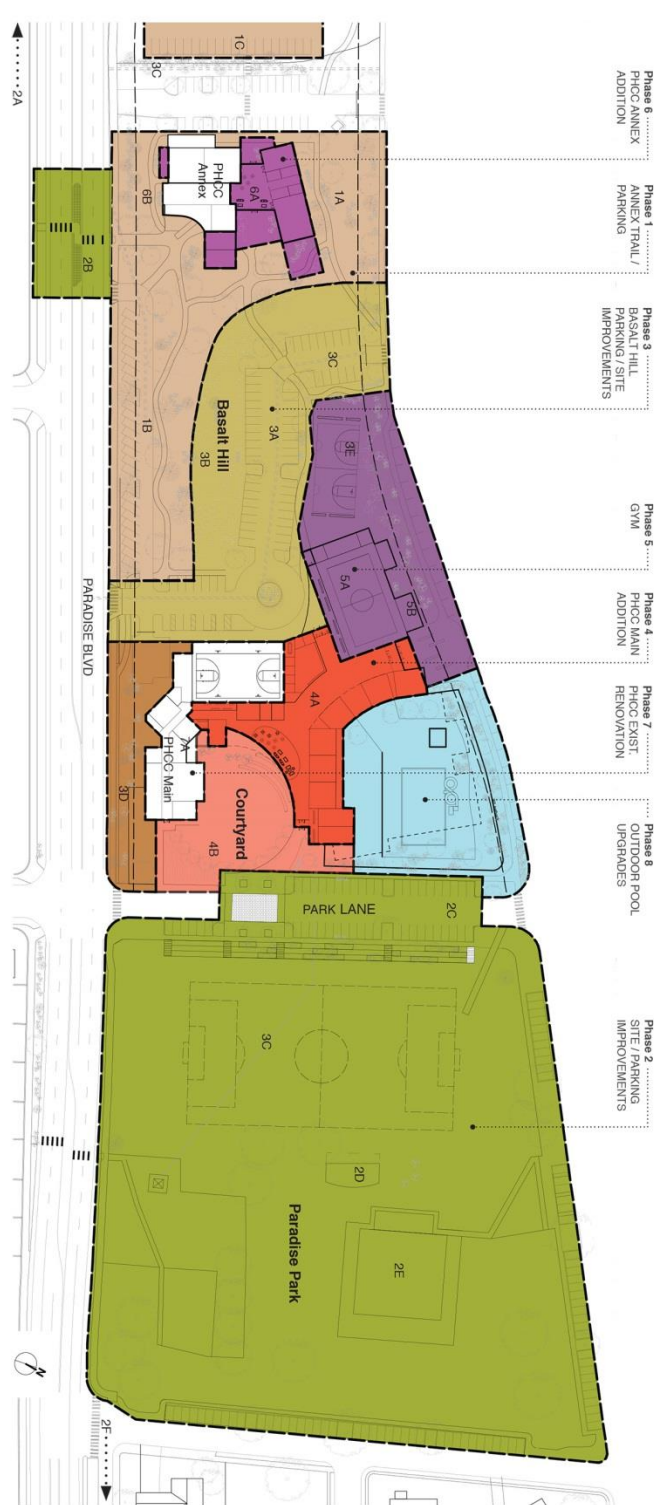

Fifty First Legislature, Second Session, 2014

AR 2014-2, #13.A4.CS. Paradise Hills CC
House #
Senate #
Commission 4